

PORSCHE

Presse-Information

PORSCHE 944 GTR

Engine Type:	Four-cylinder, in-line, water-cooled, single ignition with two valves per cylinder, single turbocharger and waste gate.
Displacement:	2478.7 cc
Power:	525 hp 1.6 bar
Camshaft:	Single overhead cam tooth-belt driven
Cylinder Head:	Aluminum/water-cooled/cross flow
Maximum Engine Speed:	7600 RPM
Maximum Car Speed:	175 MPH
Clutch:	Single Plate
Transmission:	Five-speed transaxle
Steering:	Rack & pinion, 2.5 turns lock-to-lock
Brakes:	Porsche caliper, 13x1.2 inch, ventilated discs
Wheels:	16-inch alloy three-piece modular, 10 inches wide front and 10 inches wide rear, or 12 inches wide front and rear
Suspension:	Independent by means of unequal length A-arms with anti-roll bars at front and rear. Sprung by coil springs with gas pressure shocks.
Drivetrain:	Halfshafts, limited-slip differential.
Driveshaft:	928 steel supported flexshaft
Chassis:	Tube frame with integrated rollcage
Body:	Fiberglass
Weight:	906 kilograms 1980 lbs. 2300 lbs. with ballast
Wheelbase:	2413 mm 95-in.
Front track:	1524 mm 60-in.
Rear track:	1524 mm 60-in.
Height:	1305 mm 44-in.
Width:	1905 mm 75-in.
Length:	4115 mm 162-in.
Ground clearance:	51 mm (2 3/8 in.)
Fuel capacity:	120 Liters; 31.7 U.S. Gallons
Manufacturer:	Porsche Motorsport North America Fabcar Engineering Inc.

May 1986

FABCAR ENGINEERING

INCORPORATED

2605 MOUNTAIN INDUSTRIAL BOULEVARD, UNIT 12
TUCKER, GEORGIA 30084
404/493-7111

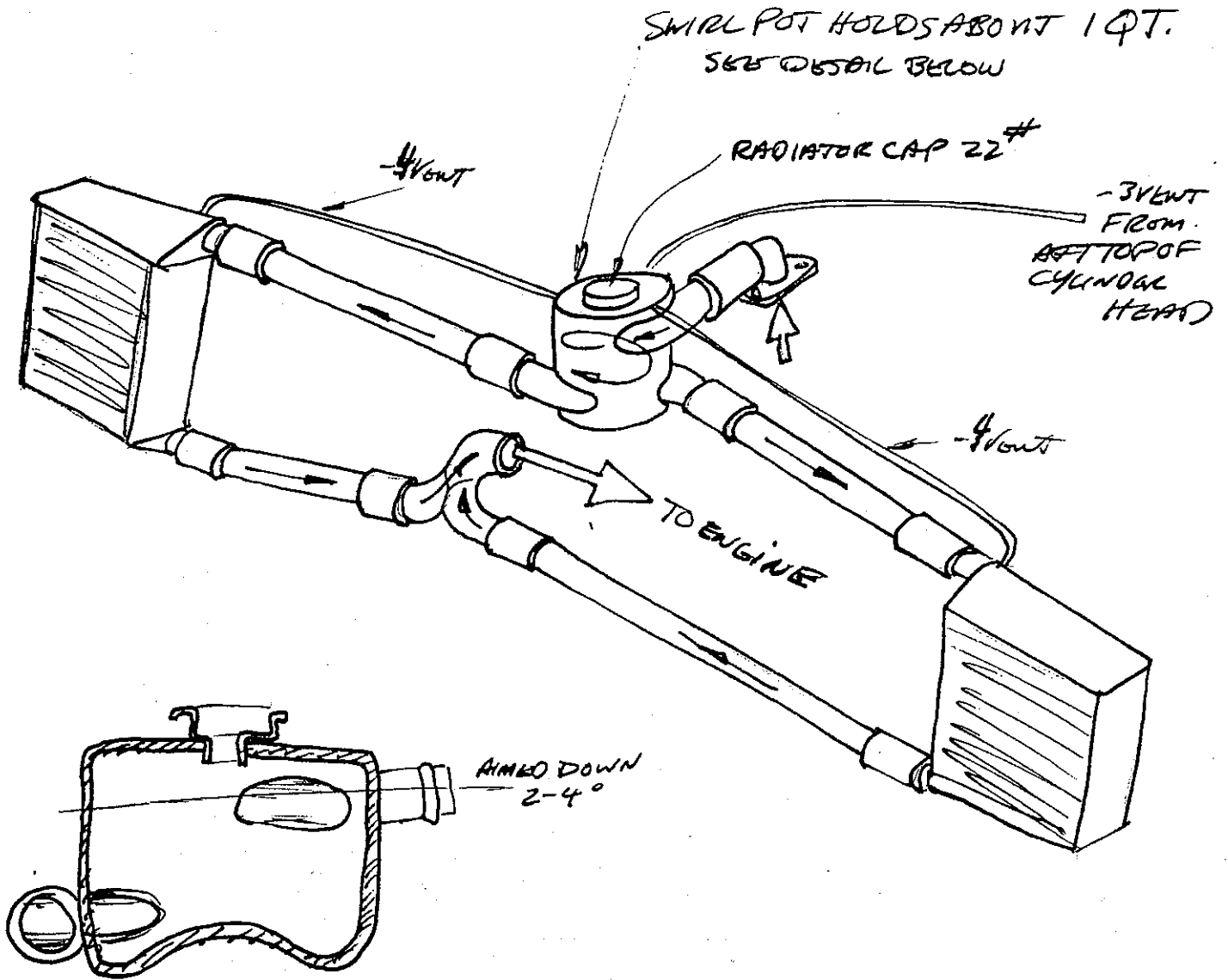

944GTB WATER SYSTEM
PARALLEL
12 MARCH 1986

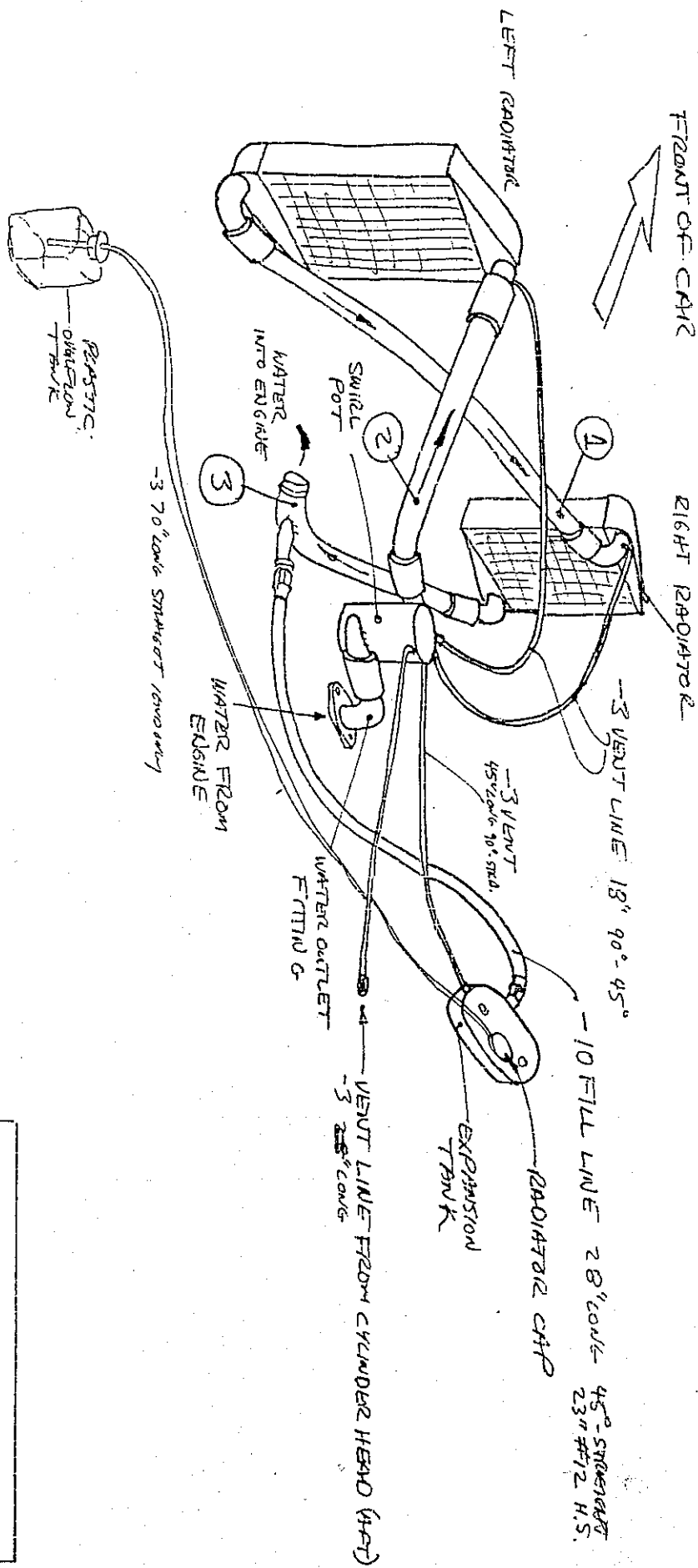

944 GTR WATER SYSTEM
 MK I OCT 1985

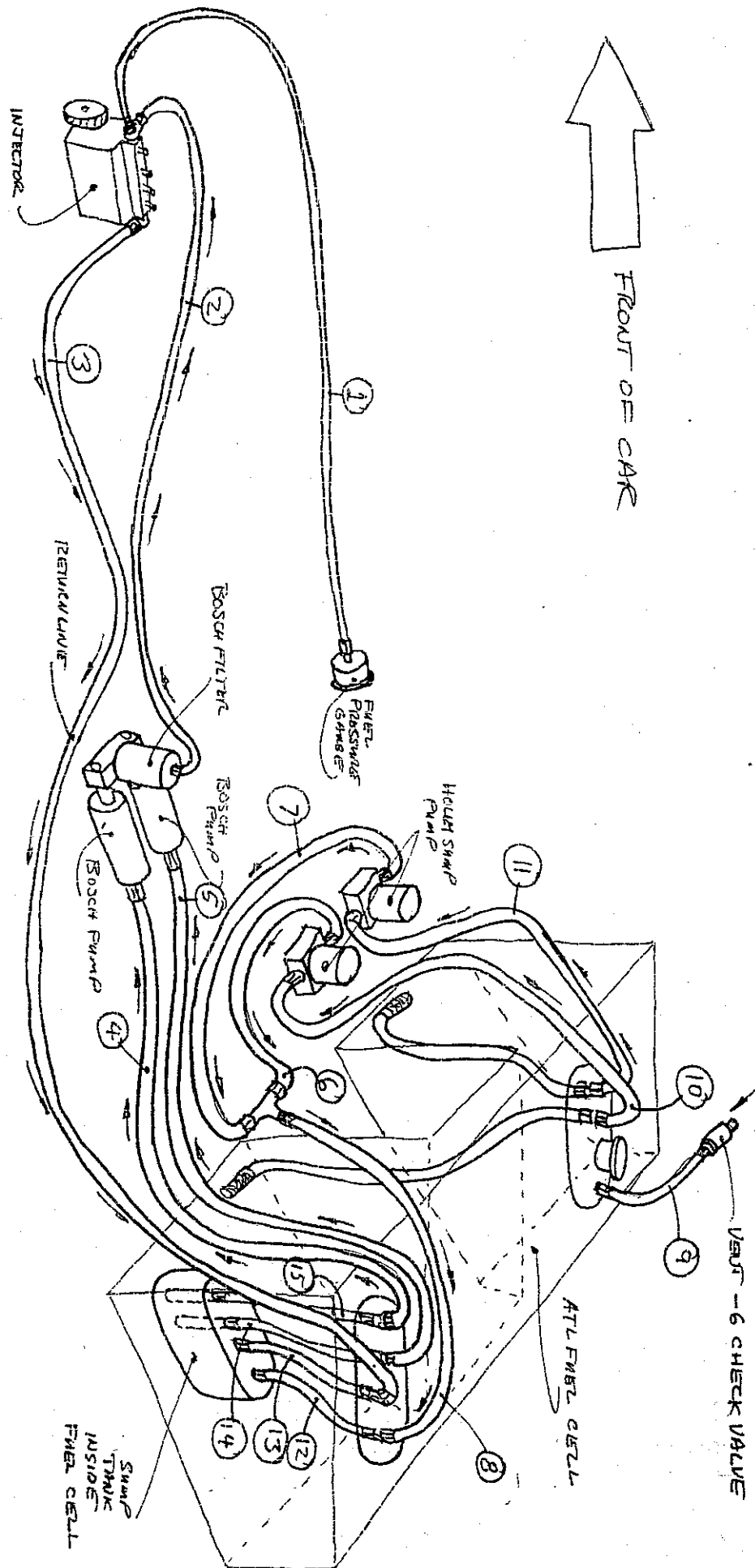

944 GTE FUEL SYSTEM
 MK I OCT 1985

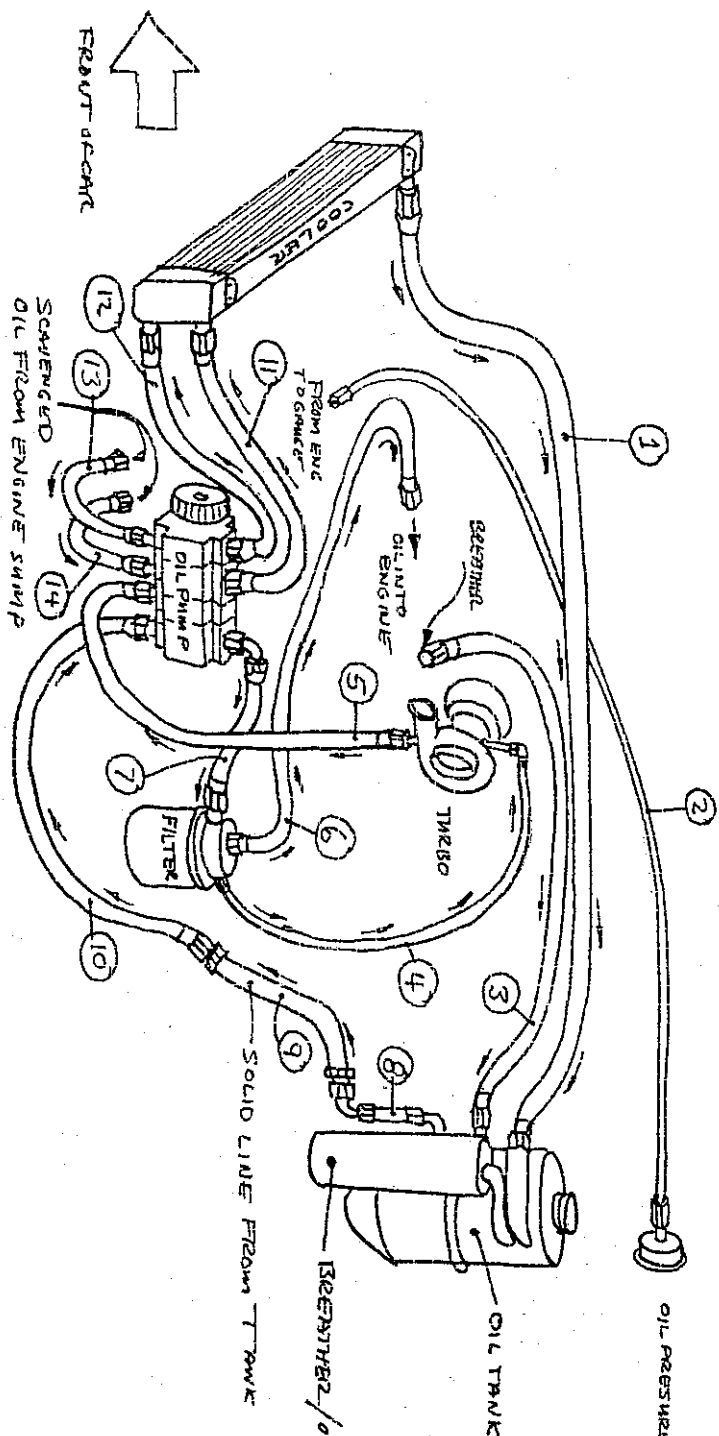

- 1-12 61" 45° STRAIGHT 3/2" x 1/8" AS
- 2-4 80" 90° STRAIGHT 3/2" x 1/8" AS
- 3-16 79" 45° STRAIGHT 3/8" x 1/8" S
- 4-4 34" 90° STRAIGHT 1/2" x 1/8" S
- 5-10 62" 45° STRAIGHT 22" x 1/8" S
- 6-12 SUPPLIED WITH GROUND
- 7-12 SUPPLIED WITH GROUND
- 8-16 13" 90° STRAIGHT
- 9-16 SOLID
- 10-16 36" 45° STRAIGHT
- 11-12 15" 90° STRAIGHT
- 12-12 15" 90° STRAIGHT
- 13-11 SUPPLIED WITH GROUND
- 14-12 SUPPLIED WITH GROUND

944 GTR OIL SYSTEM
MK I OCT 1985

SECTION 8-1
 BODY COMPONENTS

9-1-87

Picture Number	Quantity	Part Number	Description	
-	1	944 503 015 P1	Nose assembly (one piece)	
-	1	944 531 006 P1	Right door	
-	1	944 531 005 P1	Left door	
-	1	944 503 904 P1	RR quarter panel w/insert	
-	1	944 503 903 P1	LR quarter panel w/insert	
-	1	944 505 018 P1	Rear assembly w/bumper	
-	1	944 531 068 P1	Right window frame	
-	1	944 531 067 P1	Left window frame	
-	1	944 545 115 P1	Lexan rear window	
-	1	944 503 111 00	Roof	X
-	1	944 502 571 01	Windshield frame	X
-	1	944 541 011 11	Windshield	X
	1	944 503 063 P1	Nose frame/air box assy.	
	2	944 503 534 P1	Brake ducts for nose box	
	2	944 501 200 P1	Pip-pins	

SECTION 1-5
COOLING SYSTEM

9-1-87

Picture Number	Quantity	Part Number	Description
-	1	944 106 017 P1	Left water radiator
-	1	944 106 018 P1	Right water radiator

SECTION 3-1

CLUTCH, GEARBOX, & DRIVETRAIN

4-29-87

Picture number	Quantity	Part Number	Description
-	1	944 421 051 P1	Torque tube
-	1	949 116 401 00	Bell housing
-	1	944 116 050 P1	Adapter-bell hsg/torque tube
-	1	949 116 011 00	Clutch disc
-	1	944 116 235 P1	Input shaft
-	1	944 116 236 P1	Input shaft-GTO
-	1	944 116 051 P1	Coupler
-	1	944 116 052 P1	Coupler-GTO
-	1	949 116 239 00	Starter ring gear
-	1	937 307 449 02	Gearbox oil cooler

SECTION 1-9
CHARGE AIR COOLING SYSTEM

4-29-87

Picture Number	Quantity	Part Number	Description
-	1	930 110 063 01	Intercooler core

SECTION 1-10
TURBOCHARGER AND RELATED COMPONENTS

4-29-87

Picture Number	Quantity	Part Number	Description
-	1	912 111 075 00	Boost knob
-	2	999 105 046 30	Adapter M 12 x 1.5
-	-	944 123 010 P1	Garrett T-5 turbo
-	-	944 123 059 P1	Wastegate-body only
-	1	944 123 060 P1	Wastegate complete
-	1	944 123 210 P1	Diaphragm
-	1	944 123 211 P1	Wastegate valve
-	1	944 123 212 P1	Wastegate valveguide
-	1	944 123 111 P1	Wastegate heat gasket
-	2	944 123 213 P1	Wastegate clamp
-	(2)	962 123 063 00	Wastegate-Porsche
-	(2)	930 123 210 00	Diaphragm-Porsche
-	(1)	944 123 015 P1	IHI Turbo w/Q41
-	-	944 123 315 P1	Q41 turbine housing
-	(1)	944 123 013 P1	IHI Turbo w/Q38
-	-	944 123 313 P1	Q38 turbine housing
-	(1)	944 123 012 P1	IHI Turbo w/Q35
-	-	944 123 312 P1	Q35 turbine housing
-	(1)	944 123 011 P1	IHI Turbo w/Q32
-	-	944 123 311 P1	Q32 turbine housing
-	(1)	944 123 041 P1	Inlet restrictor-52mm
-	(1)	944 123 043 P1	Inlet restrictor-54mm
-	(1)	944 123 045 P1	Inlet restrictor-56mm

IHI TURBO REPLACEMENT PARTS
per turbo

-	4	15T-30	Thrust bearing screw
-	4	15T-31	Seal plate screw
-	1	33T-11	Thrust bearing
-	1	39T-48	Compressor wheel
-	2	41T-4	Journal bearing
-	1	60T-4	Thrust bushing
-	1	70T-1	Seal ring
-	1	70T-7	Seal ring
-	1	70T-10	Seal ring
-	4	258T-4	Retaining ring
-	1	223T-531	Turbine wheel & shaft
-	1	64T-509	Seal plates
-	1	81T-4	Lock nuts

SECTION 9
ELECTRICAL COMPONENTS

4-29-87

Picture number	Quantity	Part Number	Description	
-	1	901 641 632 00	150 C Temperature sender	X
-	1	930 606 121 00	120 C Temperature sender	
-	1	956 641 503 00	Combination temp. gauge	
-	1	956 641 151 00	Fuel pressure gauge-7 bar	
-	1	939 641 311 00	Oil pressure gauge-10 bar	
-	1	930 641 303 01	Boost gauge-2 bar mechanical	
-	1	771 613 572 00	Low oil pressure switch	
-	1	951 604 101 00	Starter	X
-	1	944 603 101 P1	Alternator	
-	1	944 903 119 P1	Alternator pulley	
-	1	999 192 204 50	Alternator belt	X

SECTION 8-1
BODY COMPONENTS

4-29-87

Picture Number	Quantity	Part Number	Description	
-	1	944 503 015 P1	Nose assembly (one piece)	
-	1	944 531 006 P1	Right door	
-	1	944 531 005 P1	Left door	
-	1	944 503 904 P1	RR quarter panel w/insert	
-	1	944 503 903 P1	LR quarter panel w/insert	
-	1	944 505 018 P1	Rear assembly w/bumper	
-	1	944 531 068 P1	Right window frame	
-	1	944 531 067 P1	Left window frame	
-	1	944 545 115 P1	Lexan rear window	
-	1	944 503 111 00	Roof	X
-	1	944 502 571 01	Windshield frame	X
-	1	944 541 011 11	Windshield	X

SECTION 6-3
BRAKE DISC-FRONT AND REAR

4-29-87

Picture Number	Quantity	Part Number	Description
-	2	956 351 411 02	Brake disc left
-	2	956 351 412 02	Brake disc right
-	4	944 351 110 P1	Brake hat
-	4	956 351 403 00	Ring
-	40	900 806 010 80	Bolt
-	40	900 039 002 02	Lock sheet X

HYDRAULIC-BRAKE AND CLUTCH

12-12-86

Picture Number	Quantity	Part Number	Description
10	1	999 105 084 30	Adapter
11	1	944 116 237 00	Slave cylinder
12	1		Rear brake cylinder
13	1		Front brake cylinder
14	1		Clutch master cylinder

SECTION 6-2
CALIPER-FRONT AND REAR

4-29-87

Picture Number	Quantity	Part Number	Description
-	6	956 351 935 00	Caliper without lines
-	(6)	956 351 653 00	Guide bolt for brake pad
-	(6)	900 095 002 01	Roll pin
-	-	956 351 553 00	Cover
-	(24)	930 352 561 00	Piston seal
-	(24)	956 351 704 00	Piston
-	(12)	956 351 572 00	Sleeve in caliper
-	12	956 351 573 00	Stud for caliper
-	12	956 351 571 00	Sleeve
-	12	999 084 019 02	Nut
-	6	956 351 539 00	Spring for brake pad
-	12	930 355 517 00	Bleed screw
-	3	956 355 061 00	Connecting line left
-	3	956 355 062 00	Connecting line right
-	-	956 355 515 80	Double banjo(-3)
-	8	917 355 513 01	Banjo bolt
-	8	917 355 515 00	Single banjo(-3)
-	8	N 013 808 3	Gasket ring 10 x 16
-	8	N 013 812 2	Gasket ring 12 x 15.5
-	6	956 355 683 01	Clamp
-	6	900 067 047 02	Bolt M4 x 8
-	12	956 351 939 00	Raybestos brake pad 25mm
-	(12)	956 351 937 00	Raybestos brake pad 24mm

SECTION 6-3
BRAKE DISC-FRONT AND REAR

4-29-87

Picture Number	Quantity	Part Number	Description
-	2	956 351 411 02	Brake disc left
-	2	956 351 412 02	Brake disc right
-	4	944 351 110 P1	Brake hat
-	4	956 351 403 00	Ring
-	40	900 806 010 80	Bolt
-	40	900 039 002 02	Lock sheet

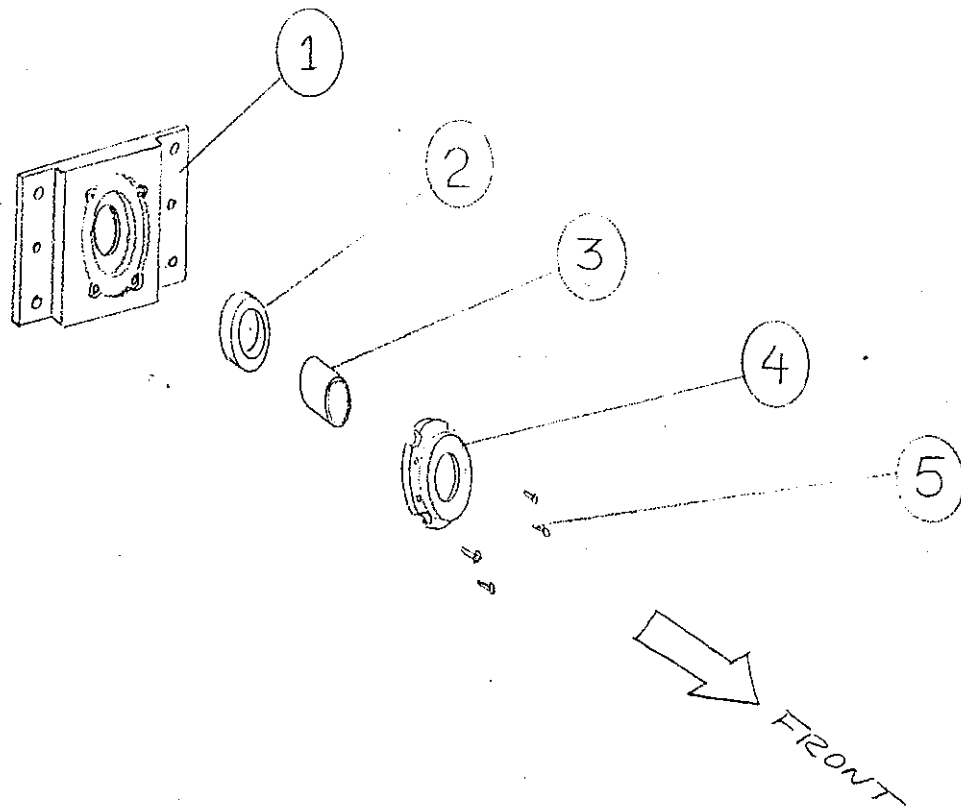

INPUT SHAFT SUPPORT BEARING

1. BELL HOUSING ADAPTOR 944 116 050 P1
2. BEARING 944116 054 P1
3. SLEEVE (PRESSED ON INPUT SHAFT AND MACHINED) N.P.N.
4. BEARING RETAINER 944 116 053 P1
- 5 10-24 X .75 SCREW (4 REQ) 900 082 075 P3

SECTION 3-1
 CLUTCH, GEARBOX, & DRIVETRAIN

9-1-87

Picture number	Quantity	Part Number	Description	
-	1	944 421 051 P1	Torque tube	
-	1	949 116 401 00	Bell housing	
1	1	944 116 050 P1	Adapter-bell hsg/torque tube	
2	1	944 116 054 P1	Bearing for input shaft	
4	1	944 116 053 P1	Bearing retainer	
5	4	900 082 075 P3	10-24 x 3/4 C.S. screw	
-	1	949 116 011 00	Clutch disc	
-	1	944 116 235 P1	Input shaft	
-	1	944 116 236 P1	Input shaft-GTO	
-	1	944 116 051 P1	Coupler	
-	1	944 116 052 P1	Coupler-GTO	
-	1	949 116 239 00	Starter ring gear	
-	1	937 307 449 02	Gearbox oil cooler	
-	1	931 116 085 00	Clutch release lever	X
-	(2)	999 201 213 00	Needle bearing	X

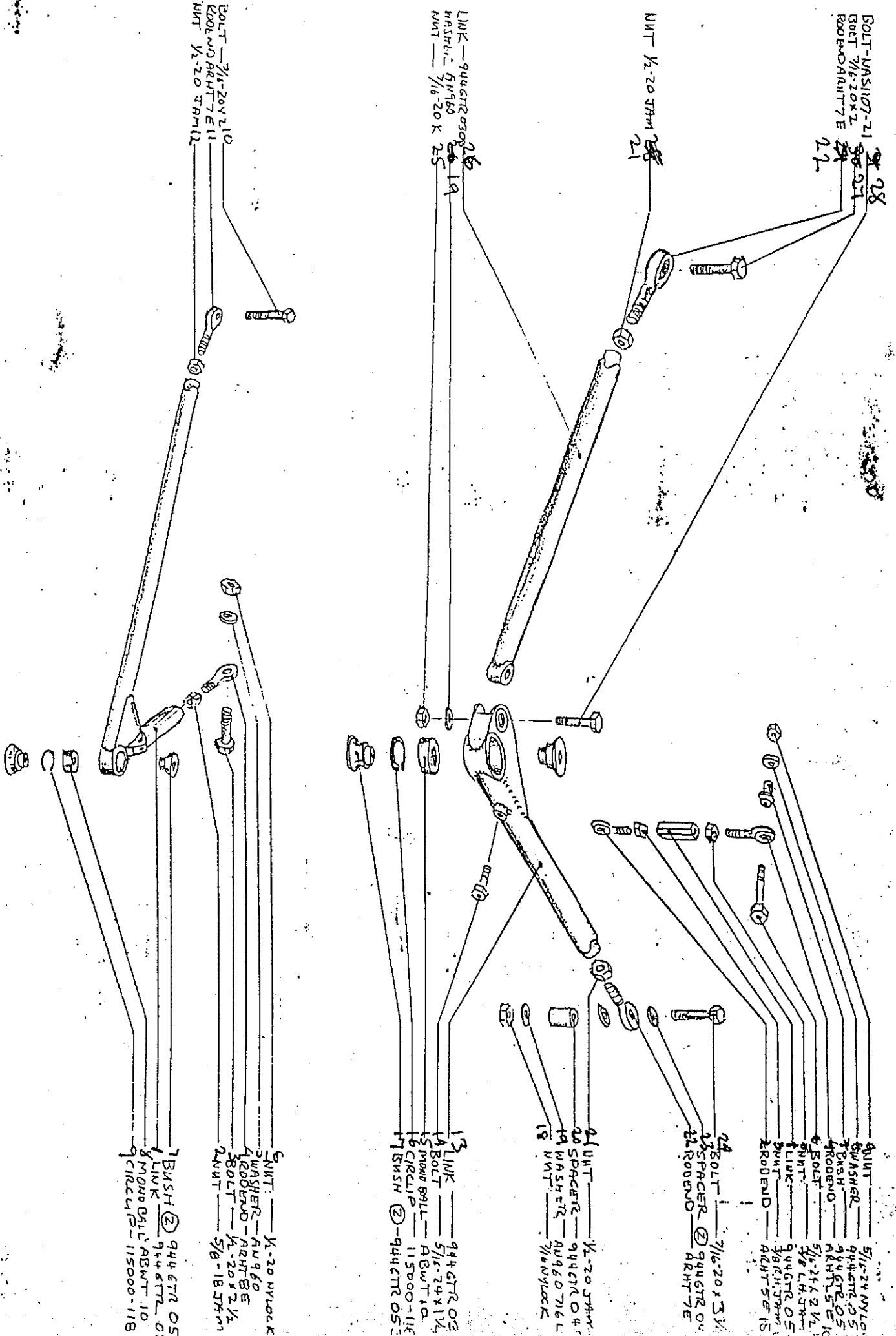

BOLT-WASH 107-21
 BOLT 7/16-20 X 2
 ROD END ARHT 7E

28
 27
 26
 25

NUT 1/2-20 5THM 21

LINK-944CTR0308
 WASH 1/2 94960
 NUT 7/16-20 K 25

BOLT 7/16-20 X 2 10
 ROD END ARHT 7E 11
 NUT 1/2-20 5THM 12

24 BOLT 7/16-20 X 3 3/4
 23 SPACER 944CTR 04
 22 ROD END ARHT 7E
 21 NUT 1/2-20 5THM
 20 SPACER 944CTR 04
 19 WASH 1/2 94960
 18 NUT 7/16-20 NYLOCK
 17 INSN 944CTR 05
 16 CIRCLIP 115000-118
 15 MOOR BRLL ABWT 10
 14 BOLT 5/16-24 X 1 1/4
 13 LINK 944CTR 03
 12 WASH 1/2 94960
 11 NUT 7/16-20 K 25
 10 BOLT 7/16-20 X 2 1/2
 9 CIRCLIP 115000-118

8 BOLT 7/16-20 X 2 1/2
 7 MOOR BRLL ABWT 10
 6 CIRCLIP 115000-118
 5 NUT 1/2-20 NYLOCK
 4 WASH 1/2 94960
 3 ROD END ARHT 7E
 2 NUT 1/2-20 5THM

944 GTR FRONT SUSPENSION WISHBONES
 RIGHT SIDE SHOWN

Front Suspension-Lower Control Arm

Picture Number	Quantity	Part Number	Description
1	1	944 341 011 P1	Lower control arm left
(1)	1	944 341 012 P1	Lower control arm right
2	2	999 095 101 P1	Jam nut
3	2	900 091 250 P1	Bolt
4	2	944 341 103 P1	Rod end
5	4	999 091 301 P1	Washer
6	2	999 091 011 P1	Lock nut
7	4	944 341 108 P1	Bush
8	2	944 341 105 P1	Monoball
9	2	944 341 107 P1	Circlip
10	2	900 089 200 P1	Bolt
11	2	944 341 110 P1	Rod end
12	2	999 091 101 P1	Jam nut

Front Suspension-Upper control arm

13	2	944 341 021 P1	Camber link
14	2	900 085 125 P1	Bolt
15	2	944 341 105 P1	Monoball
16	2	944 341 107 P1	Circlip
17	4	944 341 108 P1	Bush
18	2	999 089 011 P1	Nut
19	4	999 089 301 P1	Washer
20	2	944 341 101 P1	Spacer
21	4	999 091 101 P1	Jam Nut
22	4	944 341 110 P1	Rod-end
23	4	944 341 102 P1	Spacer
24	2	900 089 325 P1	Bolt
25	2	999 089 031 P1	Nut
26	2	944 341 020 P1	Caster link
27	2	900 089 200 P1	Bolt
28	2	900 089 175 P4	Bolt

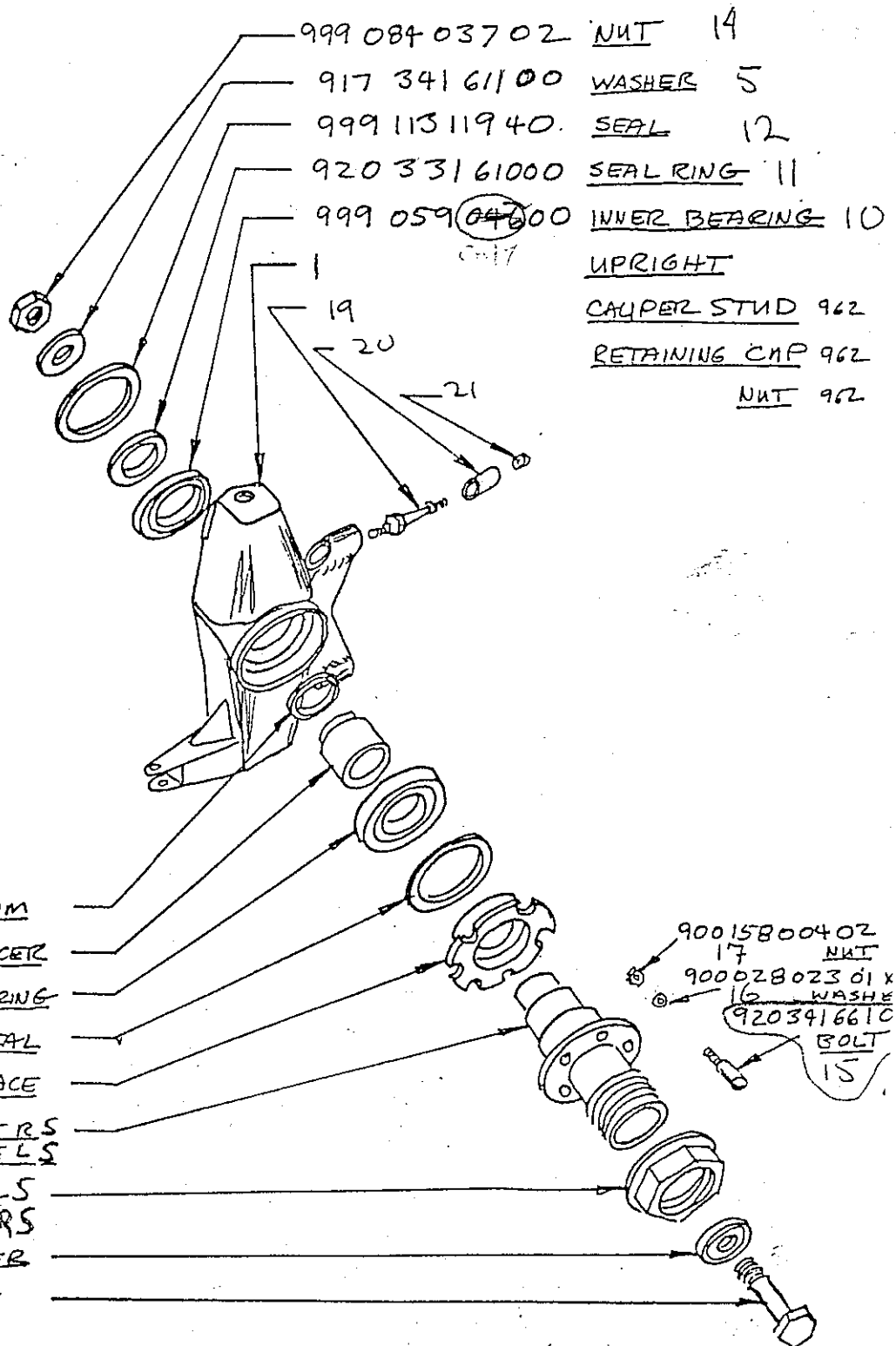

- 999 084 037 02 NUT 14
- 917 341 611 00 WASHER 5
- 999 113 119 40 SEAL 12
- 920 331 610 00 SEAL RING 11
- 999 059 ~~047~~ 00 INNER BEARING 10
- UPRIGHT
- 19
- 20
- 21
- CAUPER STUD 962
- RETAINING CAP 962
- NUT 962

- 9 917 331 611 00-09 SHIM
- 8 917 341 608 10 SPACER
- 7 999 059 ~~047~~ 00 BEARING
- 6 908 331 628 00 SEAL
- 3 917 331 619 00 SEAL RACE
- 2 935 341 602 00 SPANDLE RS
- 935 341 601 00 SPANDLE LS
- 18 935 361 141 00 NUT LS
- 935 361 142 00 RS
- 4 917 341 ~~615~~ 00 WASHER
- 13 917 331 616 01 BOLT

- 900 158 004 02 NUT 17
- 900 028 023 01 X WASHER 16
- 920 341 661 C BOLT 15

944 GTR FRONT UPRIGHT
LEFT SIDE SHOWN

SECTION 4-1
FRONT HUB ASSEMBLY

4-29-87

Picture Number	Quantity	Part Number	Description	
1	1	944 341 301 P1	Left front upright	
(1)	1	944 341 302 P1	Right front upright	
(1)	1	944 341 303 P1	LF upright w/brake ducts	
(1)	1	944 341 304 P1	RF upright w/brake ducts	
2	1	935 341 601 00	Left front hub	
(2)	1	935 341 602 00	Right front hub	
3	2	917 331 619 00	Outer seal surface	
4	2	917 341 615 00	Outer washer	
5	2	917 341 611 00	Inner washer	
6	2	908 331 628 00	Outer seal-82x104x6	
7	2	999 059 046 00	Outer wheel bearing	
8	2	917 341 608 10	Spacer	
9	2	917 331 611 00-09	Adjusting washer	
10	2	999 059 047 00	Inner wheel bearing	X
11	2	920 331 610 00	Inner seal surface	
12	2	999 113 119 40	Inner seal-58x80x5	
13	2	917 331 616 01	Through bolt	
14	2	999 084 037 02	Lock nut m16 x 1.5	
15	10	917 341 661 00	Drive pin-steel	
16	10	N 012 242 3	Washer	X
17	10	900 158 004 02	Nut m10 x 1	
18	1	935 361 141 00	Wheel nut left side	
(18)	1	935 361 142 00	Wheel nut right side	
19	8	956 351 573 00	Stud for brake caliper	
20	8	956 351 571 00	Sleeve	
21	8	999 084 019 02	Nut	X

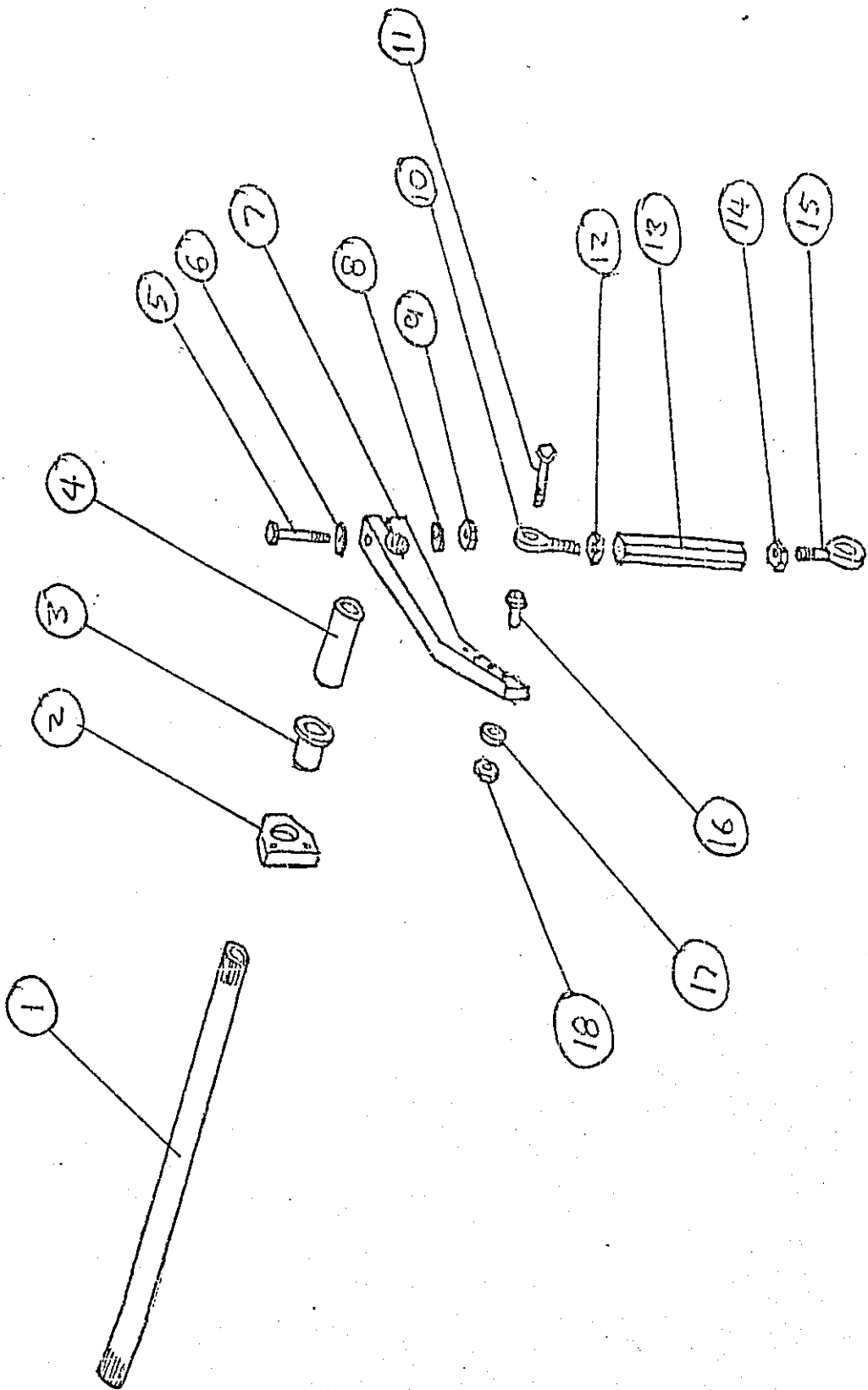

Front Suspension-Sway Bar & Link

Picture Number	Quantity	Part Number	Description
1	1	944 343 101 P1	Sway bar
2	2	944 343 102 P1	Bracket
3	2	944 343 103 P1	Bearing
4	2	944 343 104 P1	Sleeve
5	2		Bolt
6	4		Washer
7	2		Arm
9	2		Nut
10	2	944 343 071 P1	Rod-end
11	2	900 085 250 P1	Bolt
12	2	999 087 101 P2	Jam nut LH
13	2	944 343 771 P1	Link
14	2	999 087 101 P1	Jam nut
15	2	944 343 072 P1	Rod-end
16	2	944 343 772 P1	Bush
17	2	944 343 773 P1	Washer
18	2	999 085 011 P1	Nut

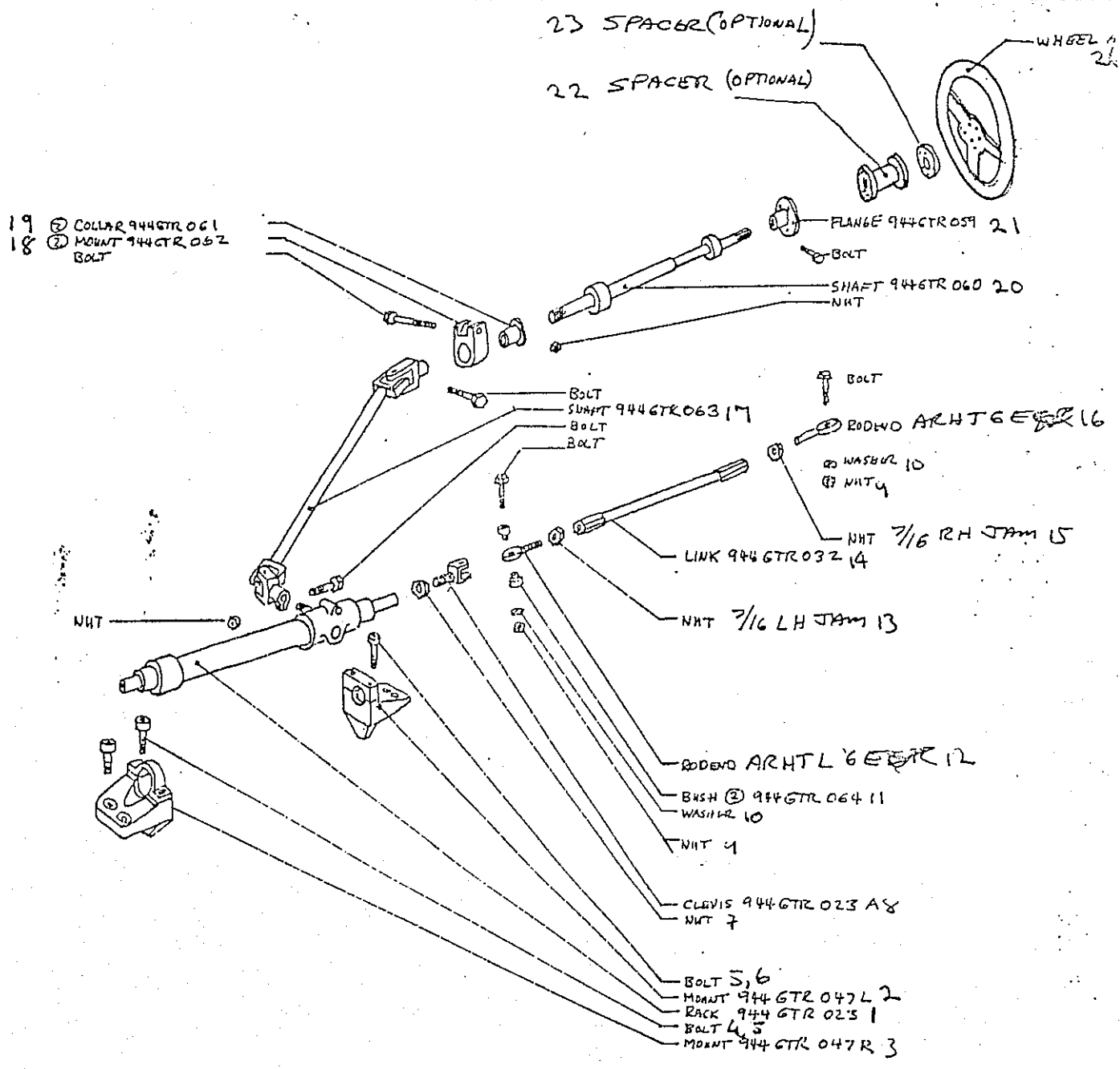

944 STEERING COMPONENTS
 JULY 1985

Steering Components

10-2-86

Picture Number	Quantity	Part Number	Description
1	1	944 347 101 P1	Steering Rack
2	1	944 347 102 P1	Mount Left
3	1	944 347 104 P1	Mount Right
4			Bolt
5			Bolt
6			Bolt
7	2		Jam nut
8	2	944 347 107 P1	Clevis
9			Nut
10			Washer
11	4	944 347 108 P1	Bush
12	2	944 347 105 P1	Rod end
13	2	999 089 101 P2	7/16 LH Jam nut
14	2	944 347 103 P1	Tie rod
15	2	999 089 101 P1	7/16 RH Jam nut
16	2	944 347 106 P1	Rod end
17	1	944 347 109 P1	Shaft w/U-joints
18	2	944 347 110 P1	Mount
19	2	944 347 111 P1	Collar
20	1	944 347 112 P1	Shaft
21	1	944 347 113 P1	Flange
22	-		Spacer
23	-		Spacer
24	1	944 347 805 P1	Steering wheel

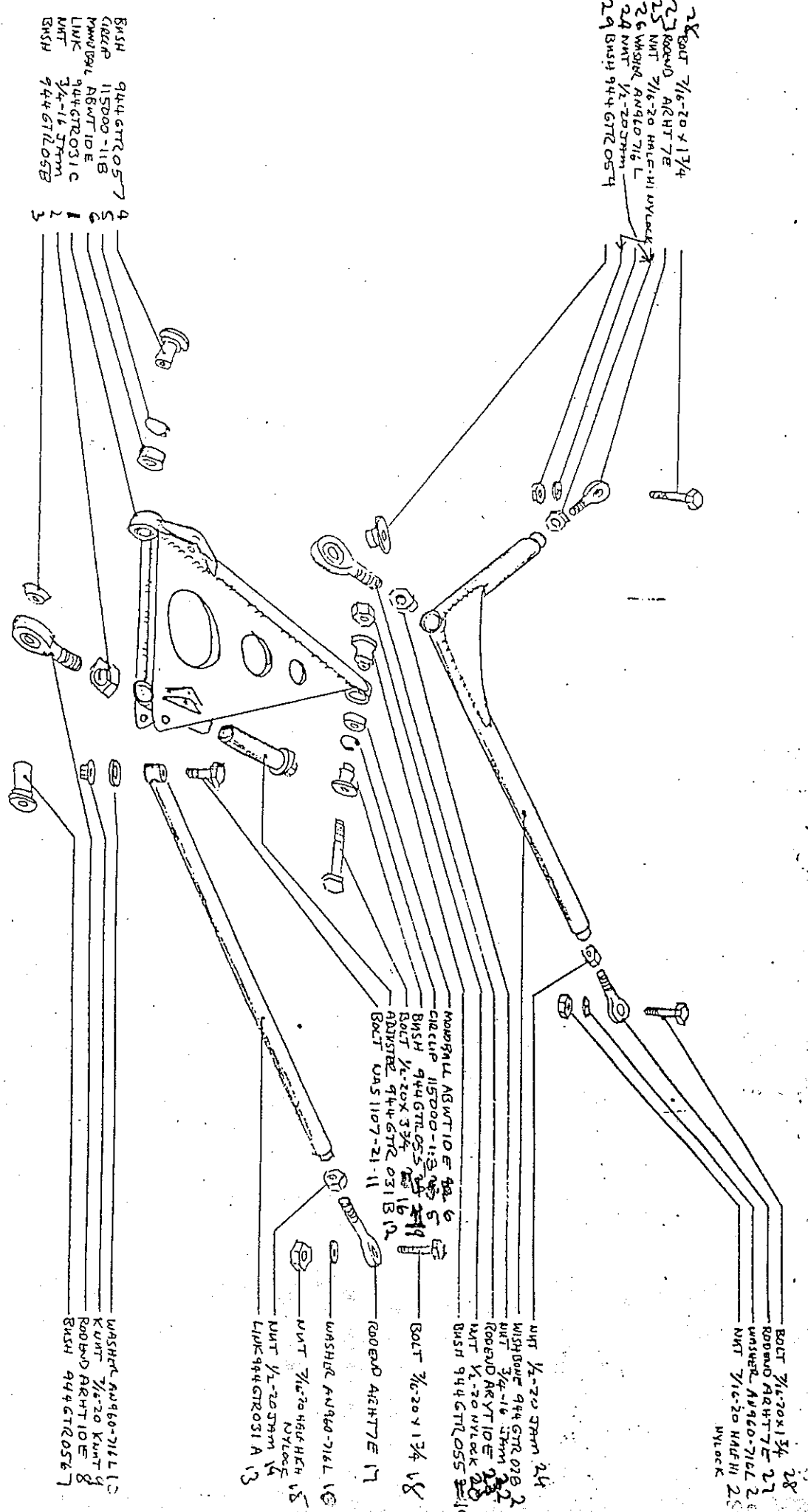

944 GTR REAR SUSPENSION WISHBONES
 RIGHT SIDE SHOWN
 JULY 1985

SECTION 5-2

REAR SUSPENSION-Lower Control Arm

1-15-87

Picture Number	Quantity	Part Number	Description
1	1	944 331 201 P1	Lower control arm left
(1)	1	944 331 202 P1	Lower control arm right
2	2	999 097 101 P1	Jam nut 3/4x16 RH
3	2	944 331 102 P1	Bush
4	2	944 331 103 P1	Bush
5	4	944 341 107 P1	Circlip
6	4	944 341 105 P1	Monoball
7	2	944 331 104 P1	Bush
8	2	944 331 105 P1	Rod end
9	2	999 089 031 P1	Nut
10	4	999 089 401 P1	Washer
11	2	900 089 175 P4	Bolt
12	2	944 331 106 P4	Adjuster
13	2	944 331 010 P1	Link
14	2	999 091 101 P1	Jam nut 1/2-20
15	2	999 089 111 P1	Nyloc nut 7/16-20
16	2	900 091 375 P1	Bolt
17	2	944 341 110 P1	Rod end
18	2	900 089 175 P1	Bolt
19	4	944 331 107 P4	Bush
20	2	999 091 011 P1	Nyloc nut 1/2-20

REAR SUSPENSION-Upper Control Arm

10-2-86

Picture Number	Quantity	Part Number	Description
21	2	944 331 101 P1	Control arm
22	2	999 097 101 P1	Jam nut 3/4-16
23	2	944 331 108 P1	Rod end
24	4	999 091 101 P1	Jam nut 1/2-20
25	4	999 089 111 P1	Nyloc 7/16-20
26	4	999 089 401 P1	Washer
27	4	944 341 110 P1	Rod end
28	4	900 089 175 P1	Bolt
29	2	944 331 109 P1	Bush

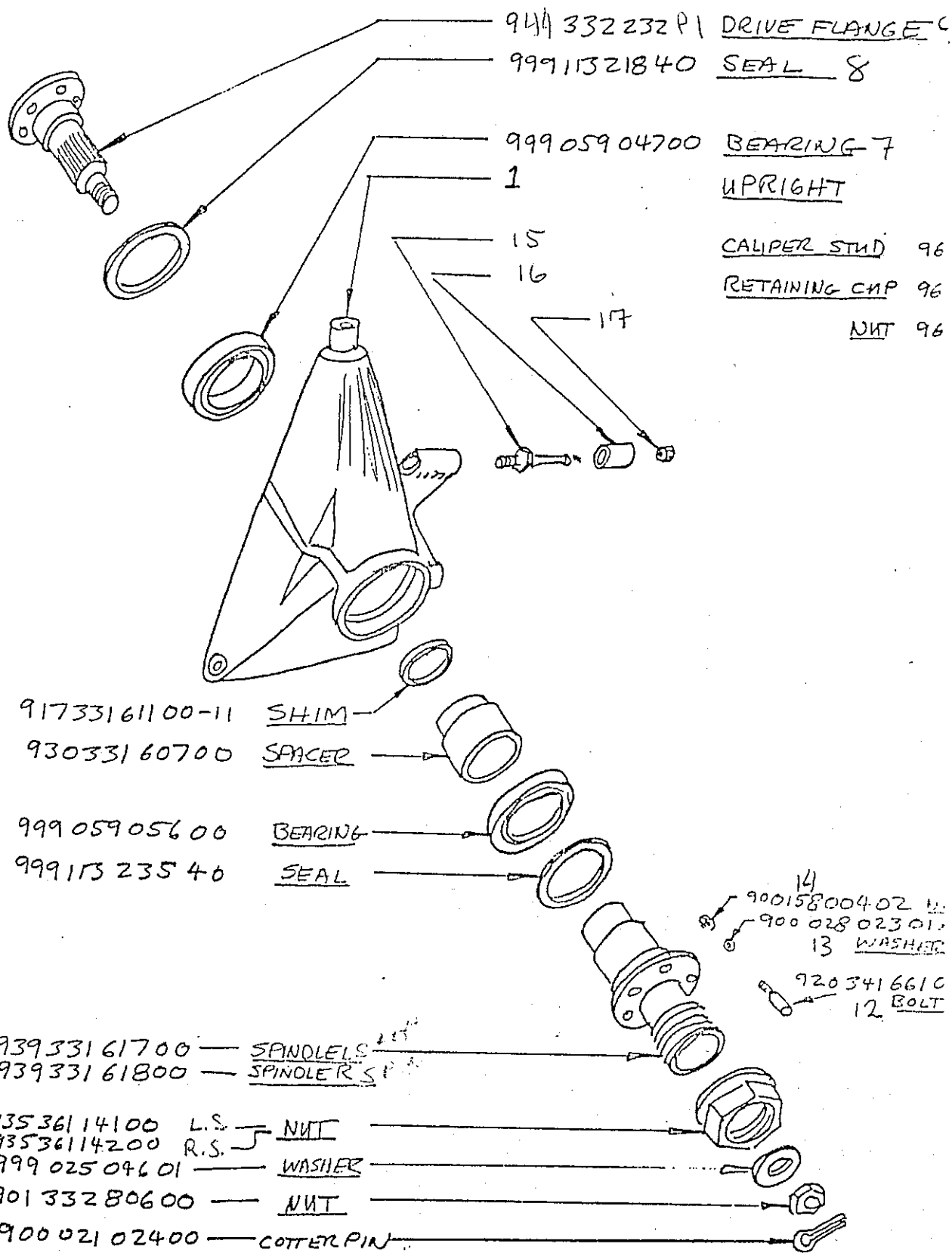

- 944 332 232 P1 DRIVE FLANGE C
- 999 113 218 40 SEAL 8
- 999 059 047 00 BEARING 7
- 1 UPRIGHT
- 15 CALIPER STUD 96
- 16 RETAINING CAP 96
- 17 NUT 96

- 6 917 331 611 00-11 SHIM
- 5 930 331 607 00 SPACER
- 4 999 059 056 00 BEARING
- 3 999 113 235 40 SEAL

- 14 900 158 004 02 W
- 900 028 023 01
- 13 WASHER
- 920 341 661 C
- 12 BOLT

- 2 939 331 617 00 SPINDLE L.S.
- 939 331 618 00 SPINDLE R.S.
- 18 935 361 141 00 L.S. NUT
- 935 361 142 00 R.S. NUT
- 10 999 025 046 01 WASHER
- 11 901 332 806 00 NUT
- 900 021 024 00 COTTER PIN

944 GTR REAR UPRIGHT

SECTION 5-1
 REAR HUB ASSEMBLY

3-18-87

Picture Number	Quantity	Part Number	Description	
1	1	944 331 301 P1	Left rear upright	
(1)	1	944 331 302 P1	Right rear upright	
2	1	939 331 617 00	Left rear hub	
(2)	1	939 331 618 00	Right rear hub	
3	2	999 113 235 40	Outer seal-65x85x8	X
4	2	999 059 056 00	Outer wheel bearing	X
5	2	930 331 607 00	Spacer sleeve	
6	2	917 331 611 00-11	Adjusting washer	
7	2	999 059 047 00	Inner wheel bearing	X
8	2	999 113 218 40	Inner seal-58x81.2x5	X
9	2	944 332 232 P1	Stub-axle	
10	2	999 025 046 01	Washer	
11	2	901 332 806 00	Nut	X
-	2	N 012 538 1	Cotter pin	X
12	10	920 341 661 00	Drive pin	
13	10	N 012 242 3	Washer	X
14	10	900 158 004 02	Nut M10 x 1	
15	4	956 351 573 00	Stud for brake caliper	
16	4	956 351 571 00	Sleeve	
17	4	999 084 019 02	Nut	X
18	1	935 361 141 00	Wheel nut left side	
(18)	1	935 361 142 00	Wheel nut right side	
-	2	944 332 010 P1	Axle shaft	
-	4	930 332 034 00	C-V joint	X
-	4	901 332 293 12	C-V Boot	X
-	4	928 332 097 00	C-V Boot flange	X
-	4	999 152 084 01	Circlip	X

- 1 57" 90°-90° 50" HEAT SHIELD
- 2 39" 90°-STRAIGHT
- 3 27" STRAIGHT-STRAIGHT
- 4 STAINLESS HARD LINE
- 5 -4 33° 90°-90°
- 6 44" STRAIGHT-STRAIGHT
- 7 24" 90°-STRAIGHT
- 8 -3 TEE
- 9 -3 TEE
- 10 96Z ADAPTOR
- 11 944 SLAVE CYLINDER
- 12 REAR BRAKE CYLINDER
- 13 FRONT BRAKE CYLINDER
- 14 CLUTCH MASTER CYLINDER

ABOVE HOSES & FITTINGS -3
UNLESS NOTED

944 GTR BRAKE CLUTCH
MK I OCT 1985

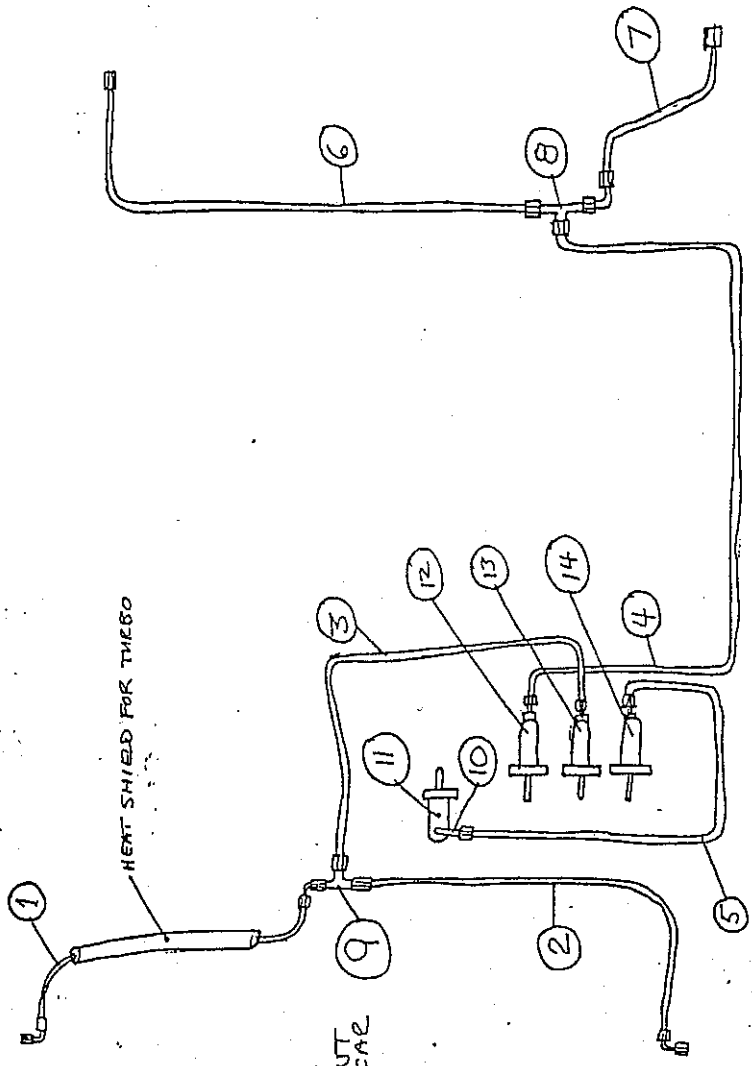

BRAKE DISC-FRONT AND REAR

10-2-86

Picture Number	Quantity	Part Number	Description
-	2	956 351 411 02	Brake disc left
-	2	956 351 412 02	Brake disc right
-	4	944 351 110 P1	Brake hat
-	4	956 351 403 00	Ring
-	40	900 806 010 80	Bolt
-	40	900 039 002 02	Lock sheet

HYDRAULIC-BRAKE AND CLUTCH

10-2-86

Picture Number	Quantity	Part Number	Description
10	1	999 105 084 30	Adapter
11	1	931 116 237 00	Slave cylinder
12	1		Rear brake cylinder
13	1		Front brake cylinder
14	1		Clutch master cylinder

944 GTR ANTI ROLL BAR

PICTURE#	QTY	PART #	DESCRIPTION
1	8		3/16 x 3/16 FEMALE ROD END
2	1		" MORSE CABLE
3	4		ADJUSTER PLATE
4	4		WASHER
5	8		10-32 JAM NUT
6	1		ADJUSTER TIE ROD
7	1		FRONT ANTI ROLL BAR
8	2		FRONT ANTI ROLL BAR BLADE
9	4		" " " " " NUT
10	2		R.H. ROD END
11	2		DROP LINK (FRONT)
12	2		L.H. ROD END
13	2		R.H. JAM NUT
14	2		L.H. JAM NUT
15	2		R.H. ROD END
16	2		R.H. JAM NUT
17	2		DROP LINK (REAR)
18	2		L.H. JAM NUT
19	2		L.H. ROD END
20	2		REAR ANTI ROLL BAR BLADE
21	1		" MORSE CABLE
22	1		REAR ANTI ROLL BAR
23	2		10-32 x 3/8 BUTTON HEAD
24	2		PHENOLIC KNOB
25	3		NYLON WASHER
26	1		SPACER SLEEVE
27	2		STEEL WASHER
28	1		BOLT
29	1		FRONT BLADE ADJUSTER
30	1		QUADRANT
31	1		REAR BLADE ADJUSTER

FRONT

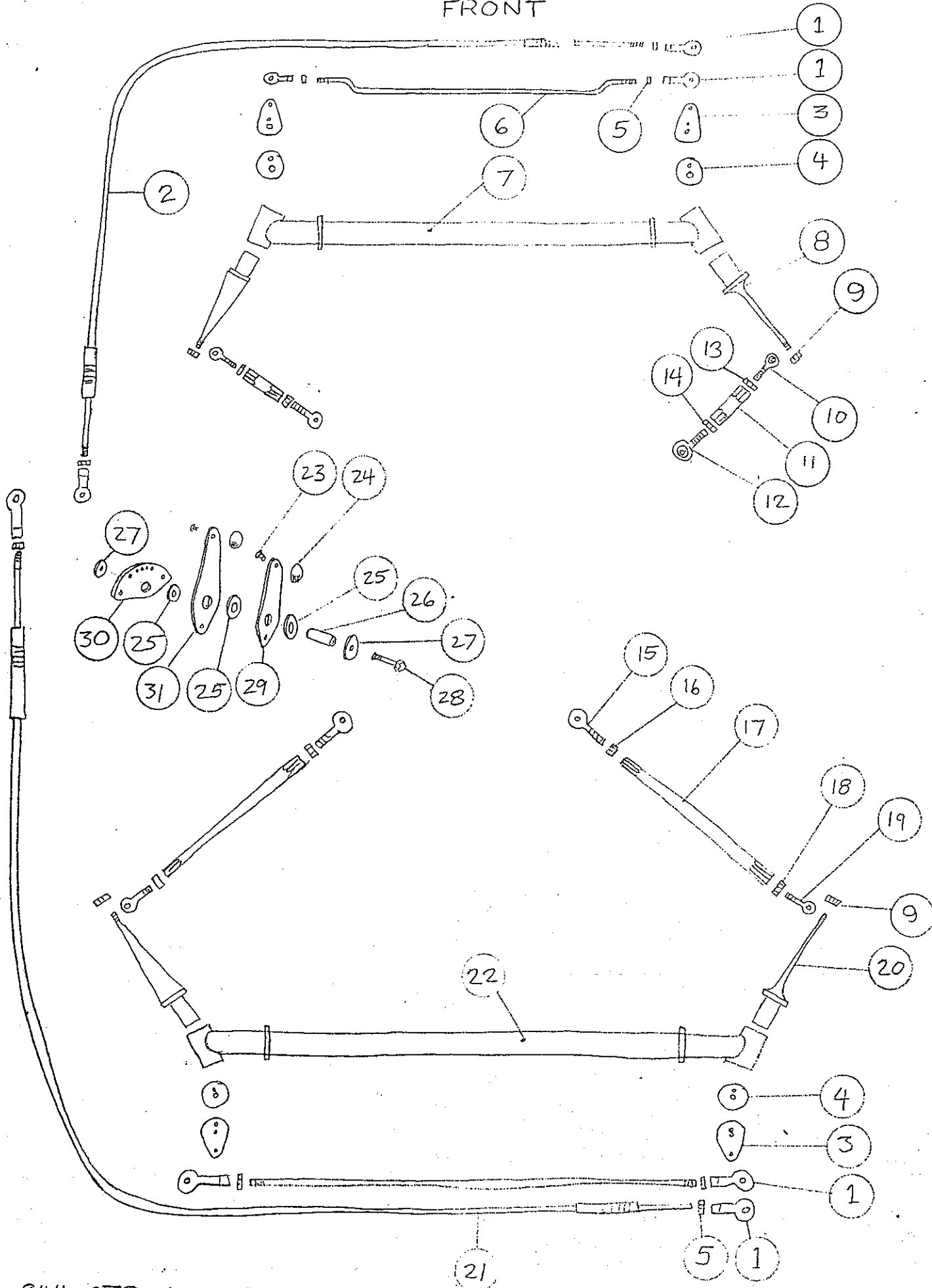

944 GTR ANTI ROLL BAR

DJK